

# FG1

## HINGE # 1017

1 x Lock Kit		
10 x M6 Washers		
4 x M5 Spring washers		
10 x Screws		
4 x Allen key bolts		
2 x Black spacers		
2 x M6 x 40mm Bolts		
6 x M6 x 20mm Bolts		
2 x Lid mount gas strut brackets	1041	
2 x Self tap ball studs	1040	
1 x Lock bracket	1054 L/H	
1 x Lock bracket	1054 R/H	
2 x Gas struts (400N)		
Alcohol wipe		
Instruction manual		
FBA Bar		

# Fitting Instructions

## Part Numbers FG1, FG2

### Ford FG Falcon

### With Out Sports Bars

F67c Fitting instructions

**Accessory Part No. P73/PR73**

**Installation Time : Approx. 60 mins**

**Place these instructions in vehicle's glove box after installation is complete.**

**Important : Check contents of kit before commencing fitment and report any discrepancies**

#### Parts List

Item	Component Name	Qty	Pre-fitted
1	Hard Tonneau Cover	1	x
2	350N Gas strut	2	x
3	Front Hinge	2	√
	Hinge Support Plate	2	√
	M8 Washer	8	√
	M8 Bolt	8	√
4	Lock bracket	2	x
	Self Drilling Screw	4	x
5	Lid Strut Bracket	2	x
	M6 Bolt	6	√
6	Body Attach Bracket	2	x
	Self Drilling Screw	6	x
7	Front Bar Assemble with Cleanseal attached	1	x
	Replacement Screw	6	x
8	Lock Set	2	√

**Note: These parts below are for a Primed Part only**

1	Foam Tape-32mmx3mmx2m	1	x
2	Foam Corners	2	x
3	Foam Tape-90mmx5mmx1.6m	3	x

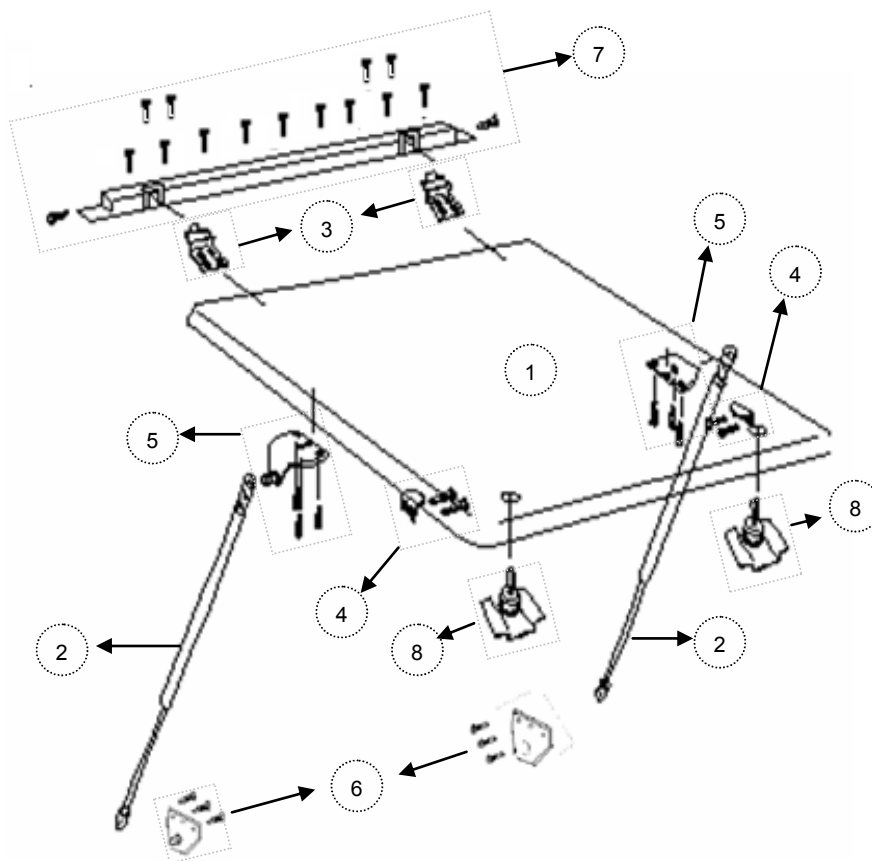

#### Tools Required:

- Masking Tape and Marking Pen
- Cordless Drill
- #2 Philips Screwdriver
- 10 mm open end spanner
- Centre Punch
- Tape Measure
- 2 mm Drill Bit ( with 5 mm stop)
- 5 mm Allen Key
- Torque wrench

#### Care Instructions:

- 1) Read Instructions fully before commencing installation.
- 2) Refer to manufactures instructions applicable to power drill.
- 3) Wear appropriate safety goggles when drilling.
- 4) Protect Tub floor against scratches during installation process.

## Fitting instructions for a Primed Tonneau :

1

Remove primed lid from the box. Turn the lid upside-down and put the lid in on a Stand. Remove hinges from the lid

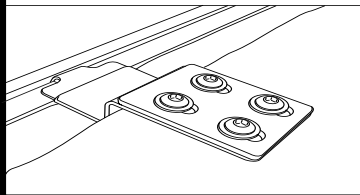

2

Remove locks from lid.



After removing all hardware from the lid, use masking paper to cover the carpet, and then mask the edges. Refer to Fig. C

Primed lid requires appropriate sanding for two pack paint application.

Recommendation:

Dry - P500 sand paper

Wet - P800 sand paper

**Note:** Sikkens 3+1 Primer has been used to prime the part.

4: Paint the lid. Make sure there is at least 4 cm boarder of paint underneath whole part. (Confirm this step is complete).

5: After the part cured, detail part.

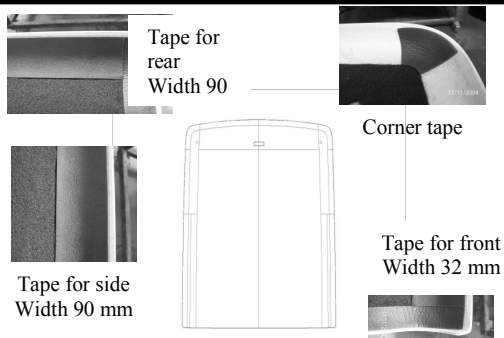

6: After detailing the part, flip the part over. Fit Gaska tapes on both rear corners. Install Gaska tape across the front edge of the lid and along both side

7: Re-install hinges. Recommended tightening torque is 6 Nm.

8: Ensure both locks are keyed alike and both locks operate correctly. The following pictures show lock assembly instructions for passenger side lock (Driver side lock is assembled by using the same instruction but be careful with direction of notch and lock tongue – see below diagrams)

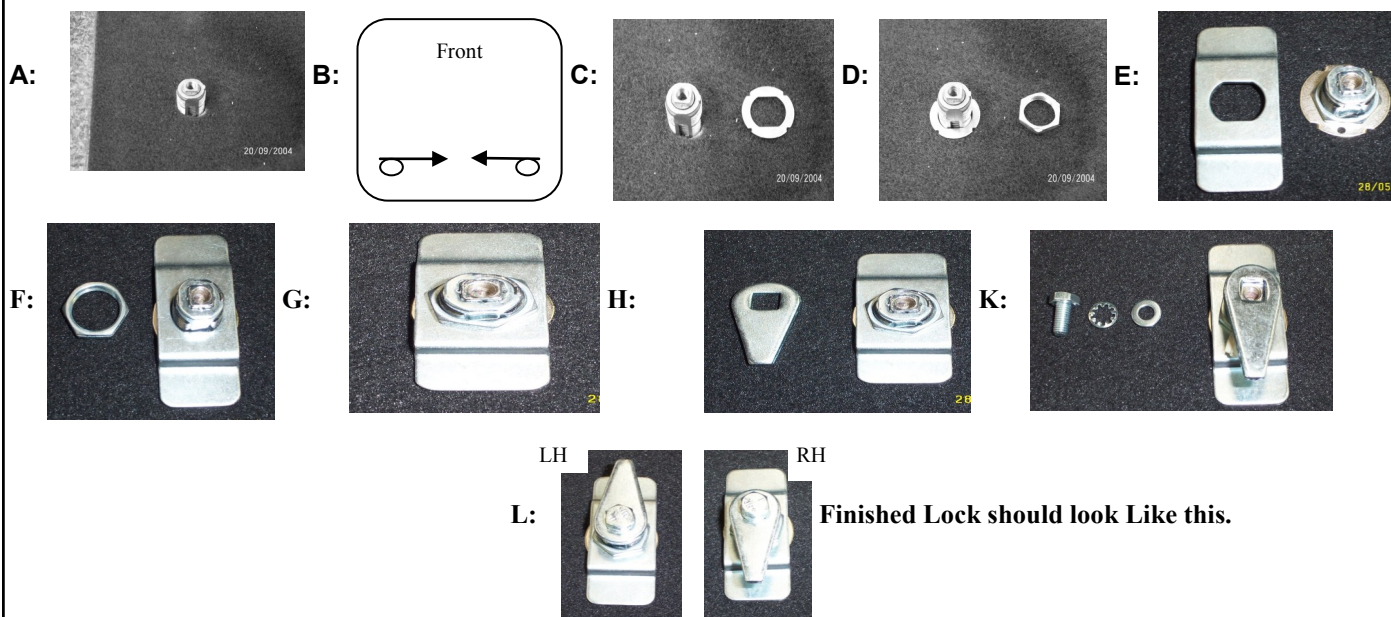

Finished Lock should look Like this.

**CAUTION:**

Over tightening fasteners attached to the Hard Tonneau cover may damage the threaded inserts. Please use recommended tightening torques where specified.

**1.** Remove the existing Header bar from the front of the tub using a T25 Torx screw bit, remove the 1 screws on each of the inside sections and 4 across the top of the header bar. Remove the Header bar.

**2. Then the Front Bar Assembly (FBA) Should be fitted.**

The FBA will already have the hinges fitted to it. Align the bar along front top of tray where the existing header bar was taken off, and replace with longer screws provided both on top and sides. Remove red plastic tape from rubber seal and attach extension of the seal to the tub.

- 3.** Hook tape measure over front edge of tub, measure along top edge of tray **920 mm** (windscreen end) then down **80mm** and mark the screws position for the gas strut bracket. Position the gas strut bracket accordingly, mark two mounting holes and centre  
**Refer to Fig. 1 and Fig. 2**

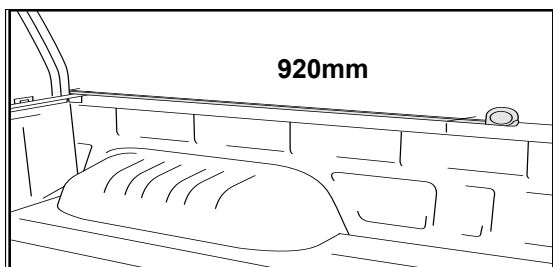
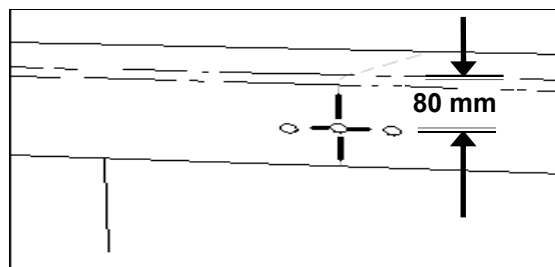
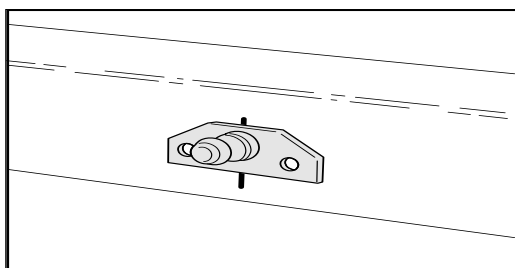
**Fig.1 - Gas strut bracket location****Fig.2 - Gas strut bracket location****Fig. 3 - Gas strut bracket fitment**

- 4.** Using a **2 mm** diameter drill bit set to **5 mm** drill stop. Drill two pilot holes. Attach small gas strut bracket using self drilling screws provided. Repeat process on other side of tray.  
**Refer to Fig. 2 and Fig.3**

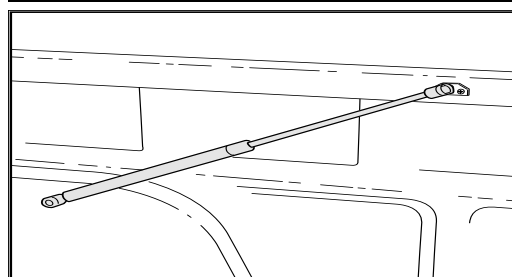
**Fig.4 - Gas strut orientation**

- 5.** Attach small shaft end of gas strut onto gas strut brackets, by clicking them in place.

**Refer to Fig.4 with regard to gas strut orientation.**

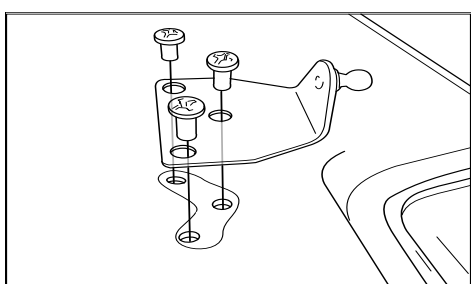
**Fig. 5- Hard Cover strut bracket**

- 6.** With the lid on the floor and taking care to prevent damage or scratches to the painted surface, unscrew the 6 Phillips head screws from the underside of the Hard Tonneau Cover (3 per side) and use them to fit the upper gas strut mounting brackets to the lid.

**Refer to Fig. 5**



**Important:**

**DO NOT over tighten screws.  
Recommended tightening torque is 1- 3 Nm**

7. With one person on each side, lift lid to the vertical position and insert the hinge tongues into the hinge slots on the front bar assembly.

**Refer to Fig. 6 and Fig. 7**

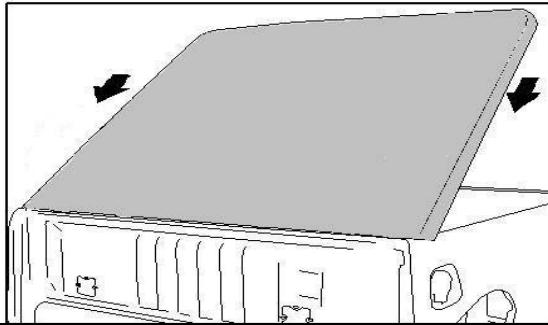

**Fig. 6 - Lift Lid near vertical and carefully**

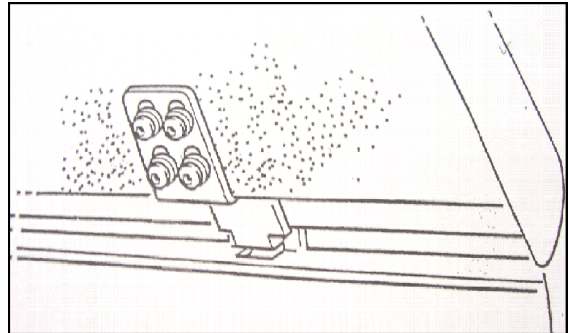

**Fig.7 - Hard Cover strut bracket location**

**Important:**



**Ensure tongues are fully inserted into the hinge slots.**

**Fig.8 - Attach gas strut**

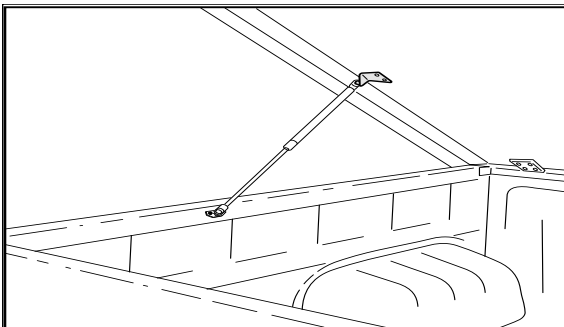

8. With the Hard Tonneau Cover opened, attach the cylinder end of each gas strut onto the mounting brackets attached to the Hard Tonneau Cover by clicking into place

**Refer to Fig. 8**

**Fig. 9 - Remove gas strut**

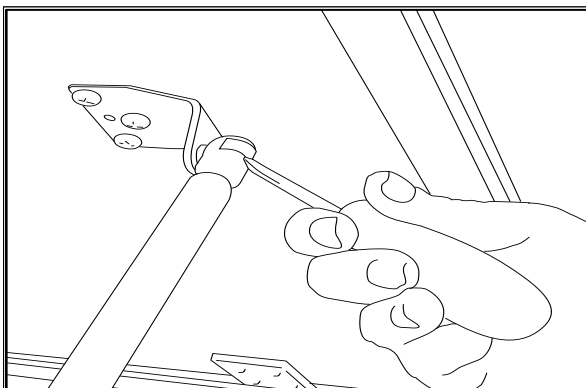

**Important:**



**To remove the Hard Tonneau Cover from the vehicle, detach the gas struts from the Hard Tonneau Cover. This is done by inserting a small screwdriver under the metal spring clip on the strut and easing it out sufficiently to allow the strut to be popped off the ball (Refer to Fig 9). From inside of tub , remove 4 bolts from each hinge bracket.  
Ensure someone is supporting the lid when detaching. Never completely remove the metal spring clip from the gas strut end, and never force the strut off the ball.**

9. Close Hard Tonneau Cover and check it fits snugly and evenly around all sides. Make sure it also fits down snugly over the tailgate. If it does not, then adjust as follows:
- a Open Hard Tonneau Cover, disconnect struts from Hard Tonneau Cover. **Refer to Fig. 9.**
  - b One person needs to lie on their back in the utility while second person closes Hard Tonneau Cover. With the Hard Tonneau Cover closed, loosen four Allen key bolts on each side of the two hinge tongues on Hard Tonneau Cover. Adjust the fit by setting Hard Tonneau Cover into ideal position. The person in the utility then re-tighten the Allen head bolts.
  - c Open Hard Tonneau Cover and reattach gas struts.

**Fig.10 - Install lock bracket**

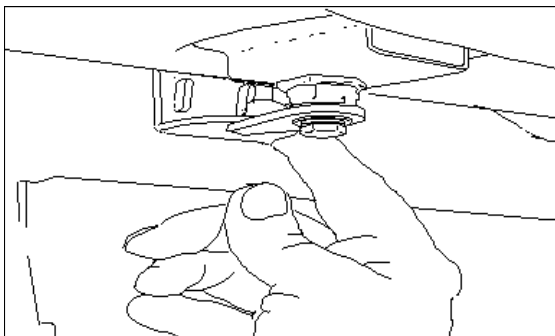

10. To fit lock brackets, open tailgate and close Hard Tonneau Cover. Make a mark where the lock cam (arm) lines up with the sides of the tub. Open Hard Tonneau Cover to install lock bracket. Position lock bracket and using a 2 mm diameter drill bit set to 5 mm drill stop to drill a pilot hole in each vertical slot of the bracket. Ensure that there is allowance for up and down adjustment of the bracket. Fasten bracket with self-drilling screws (supplied) ensuring thread installs into metal of Ute rail, again allowing for up and down adjustment. **Refer to Fig. 10**

**Fig.11 - Lock bracket adjustment**

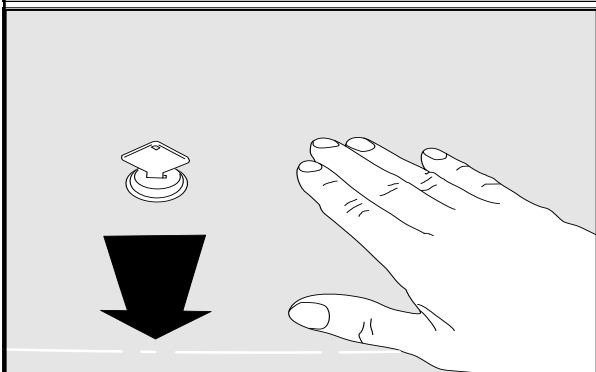

11. Close the Hard Tonneau Cover and try the locks. You may need to adjust the lock brackets on the Ute tub up or down. When correctly adjusted, you should need to apply **slight** pressure to the lid in order to operate the locks. **Refer to Fig. 11.**



**Important:** Excess tension could damage the lock.



**NOTE:** Please ensure Lid is kept lock at all times when not being used, for both Safety and Longevity.

**Maintenance:** Check tightness of brackets regularly. Lubricate locks monthly with graphite.

**Paint care instructions:** Your new painted Hard Tonneau Cover has been covered with a plastic film to protect the paint from damage. It will require cleaning and possibly light polishing after the protective film has been removed. Use polish as per new paint on a new vehicle. Wash Hard Tonneau Cover using water and normal carwash detergent and polish with an automotive polish.

Having trouble?  
Please Call your supplier

Make a note of the key Number on  
these fitting instructions for future reference:

Key No: